

# DSP420

Digital Signal Processing  
In-Wall Loudspeaker System

## INSTALLATION & OPERATION

### Fitting Instructions

**See separate sheet for important safety instructions!** Illustrations are not all to the same scale.

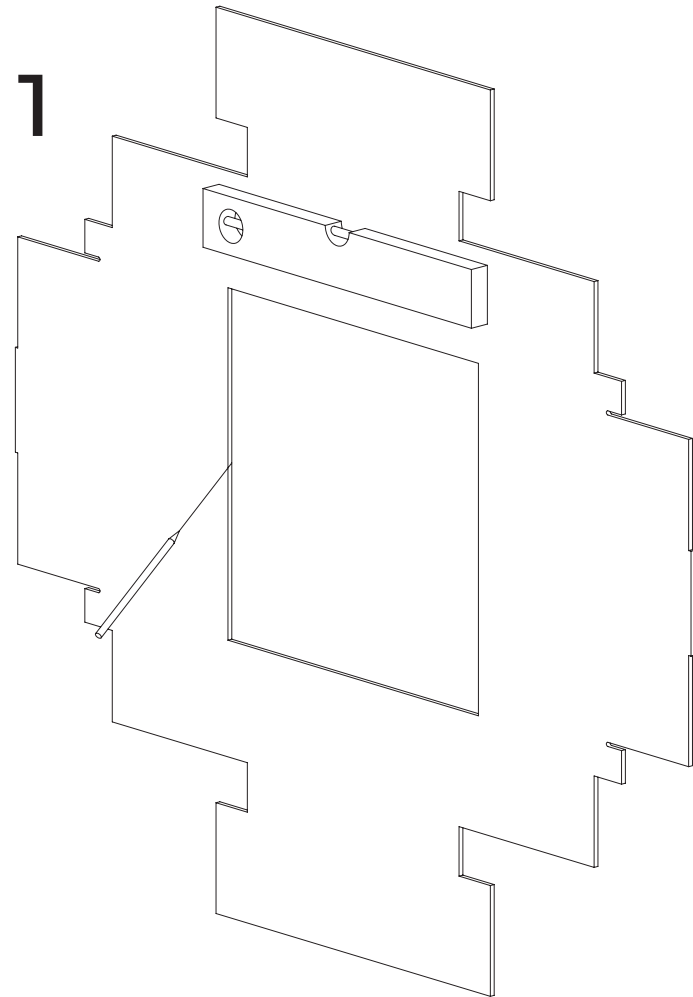

**Step 1:** Use the template (provided as part of the packaging) to mark wall for cut-out (far left). Position equally between battens. Use this alternative method (left) to mark battens prior to wall covering.

2

**Step 2:** Ensure that 12in (300mm) of each cable is present in the wall cut-out.

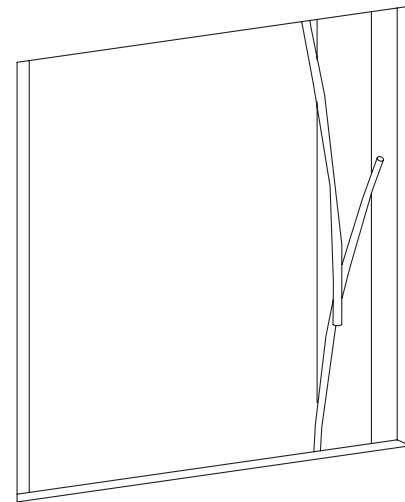

4

**Step 4:** Tidy and clamp all cables. Fit covers to power and audio boxes.

5

**Step 5:** Carefully connect power and audio between loudspeaker unit and back box. An IEC connector is used for power; DSUB for digital audio. Be sure to install the digital cable with the choke on the end next to the speaker.

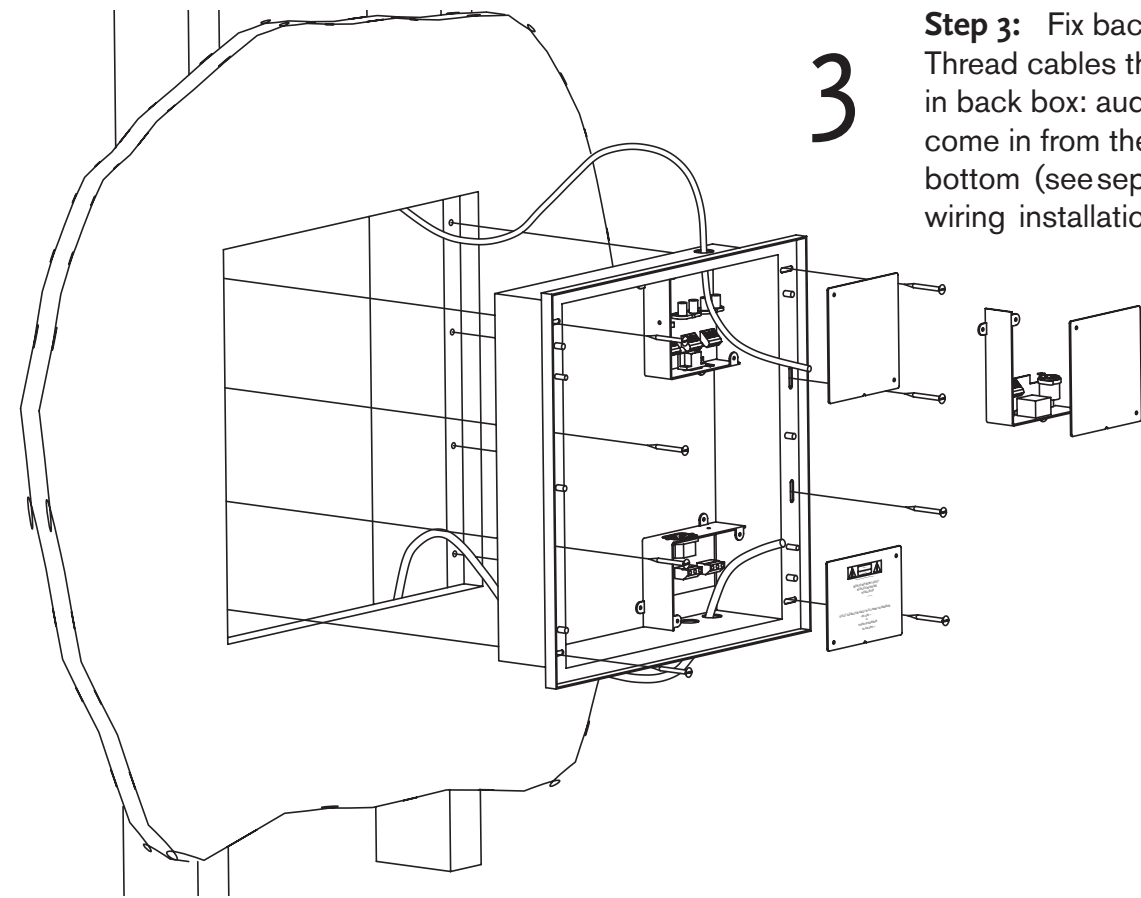
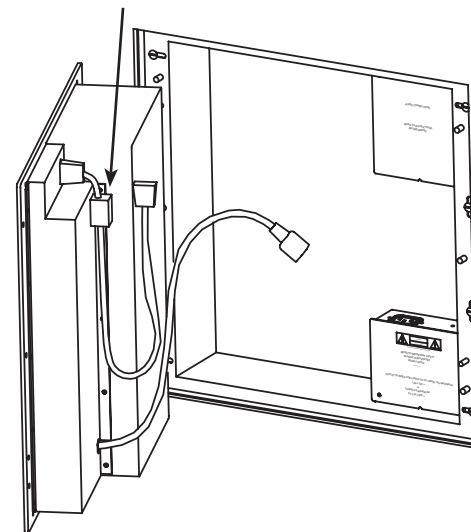

3

**Step 3:** Fix back-box into cut-out. Thread cables through correct holes in back box: audio/comms cables come in from the top; power from the bottom (see separate sheet for power wiring installation instructions).

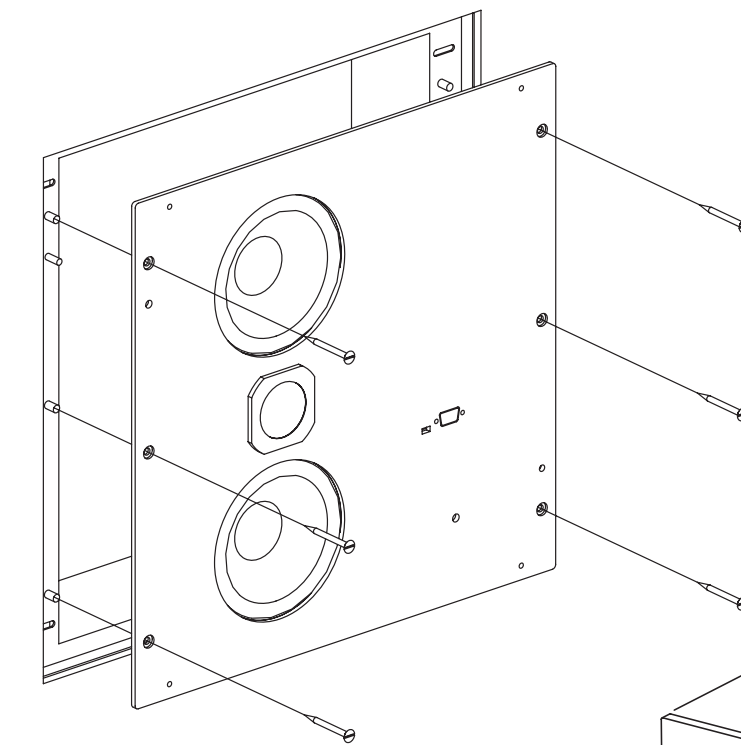

6

**Step 6:** Neatly position power and comm cables and push the loudspeaker unit all the way in so that it locates on the pegs in the back-box. Secure using the six M5 x 12 button-head socket screws supplied, Meridian part number H61513.

7

**Step 7:** Secure frame and fit grille. Grille can be *carefully* removed using the extraction tools supplied.

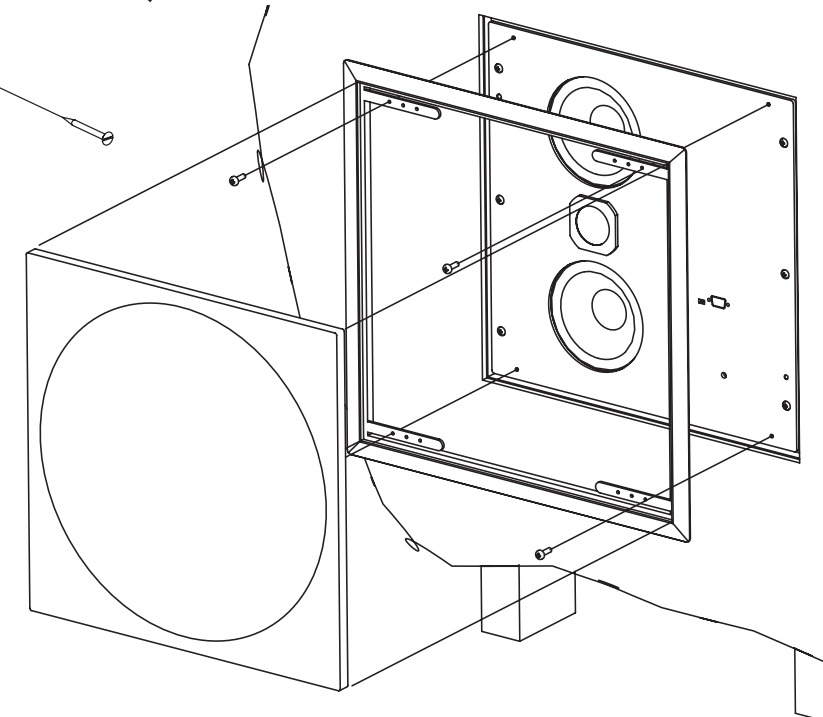

# DSP420

Digital Signal Processing  
In-Wall Loudspeaker System

## INSTALLATION & OPERATION

### Audio wiring instructions

First remove the cover labelled audio connections.

#### DSP420

A remote IR connection can be optionally accommodated from a remote sensor such as a Meridian G12 or 512, which can be wired to a master speaker as follows: Red to +8V, blue to IR and screen GND.

### Connecting a pair of DSP420s as a stereo system

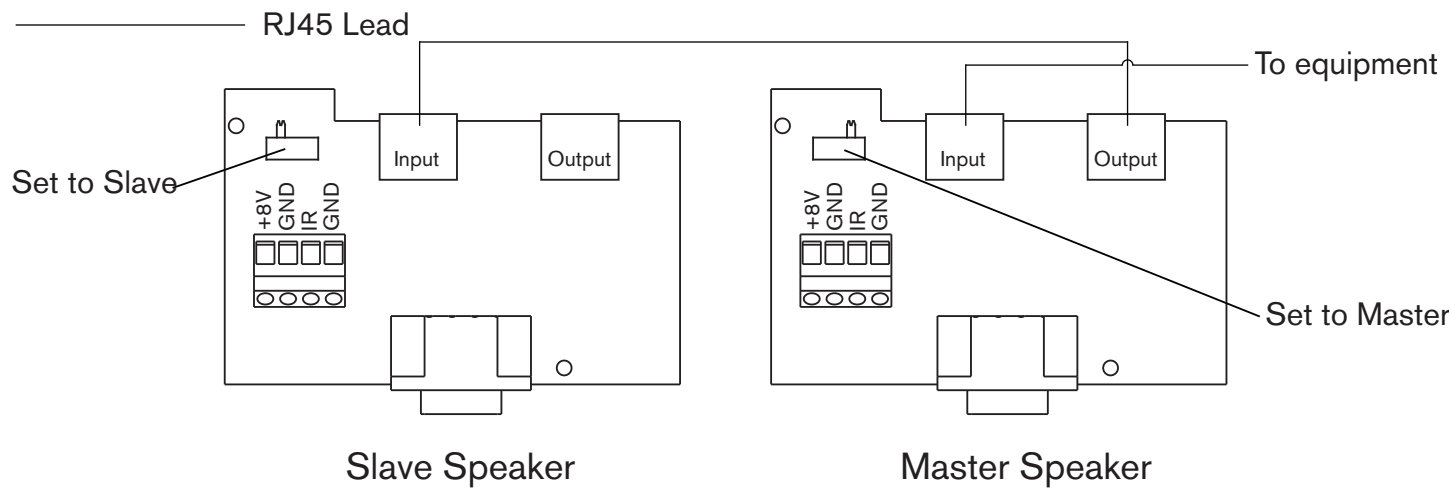

### Outline Specifications

Inputs:	Meridian SpeakerLink (RJ45) input & output providing balanced digital Meridian Comms and Power.
Enclosure:	Aluminium front baffle with sealed, mechanically damped and insulated acoustic enclosure. Baffle finished in textured black enamel. Grille finished in easy-to-paint white powder coat, backed by acoustically-transparent scrim. White moulded custom paintable frame.
Acoustics:	2-way Infinite Baffle enclosure. 2x 127mm high-efficiency long-throw custom bass drivers, 1x Meridian 25mm tweeter with aluminium
Response:	55Hz – 20kHz $\pm$ 3dB.

Amplification:	Internal 85W woofer, 65W tweeter. 6VA (quiescent) – 200VA (full output).
DSP (DSP420):	100MHz Motorola 56364, Linear Phase Crossover, 96kHz, 24-bit DAC.
Controls & Indicators:	Front baffle controls for power and channel selection. LED indicators for power, lock and thermal warning.
Approx. Dimensions:	Frame 450mm (17.72in) square, depth 102mm (4.02in) Hole cutout 357 x 388mm (14.10 x 15.28in) Note: dimensions are approximate. See installation drawings for detailed information. The DSP420 is designed to fit standard 16in stud centres.
Approx. Weight:	8.5 kg (18.7 lb) main unit without frame, grille or connection boxes.
Mounting:	Easy-install frame with fire-retardant power and audio connection boxes. Templates provided for both new construction and installation into existing walls.

### Example installation: 861 Surround controller with seven DSP420

Key  
Digital Audio  
Meridian Comms (BNC or DIN)  
SpeakerLink RJ45

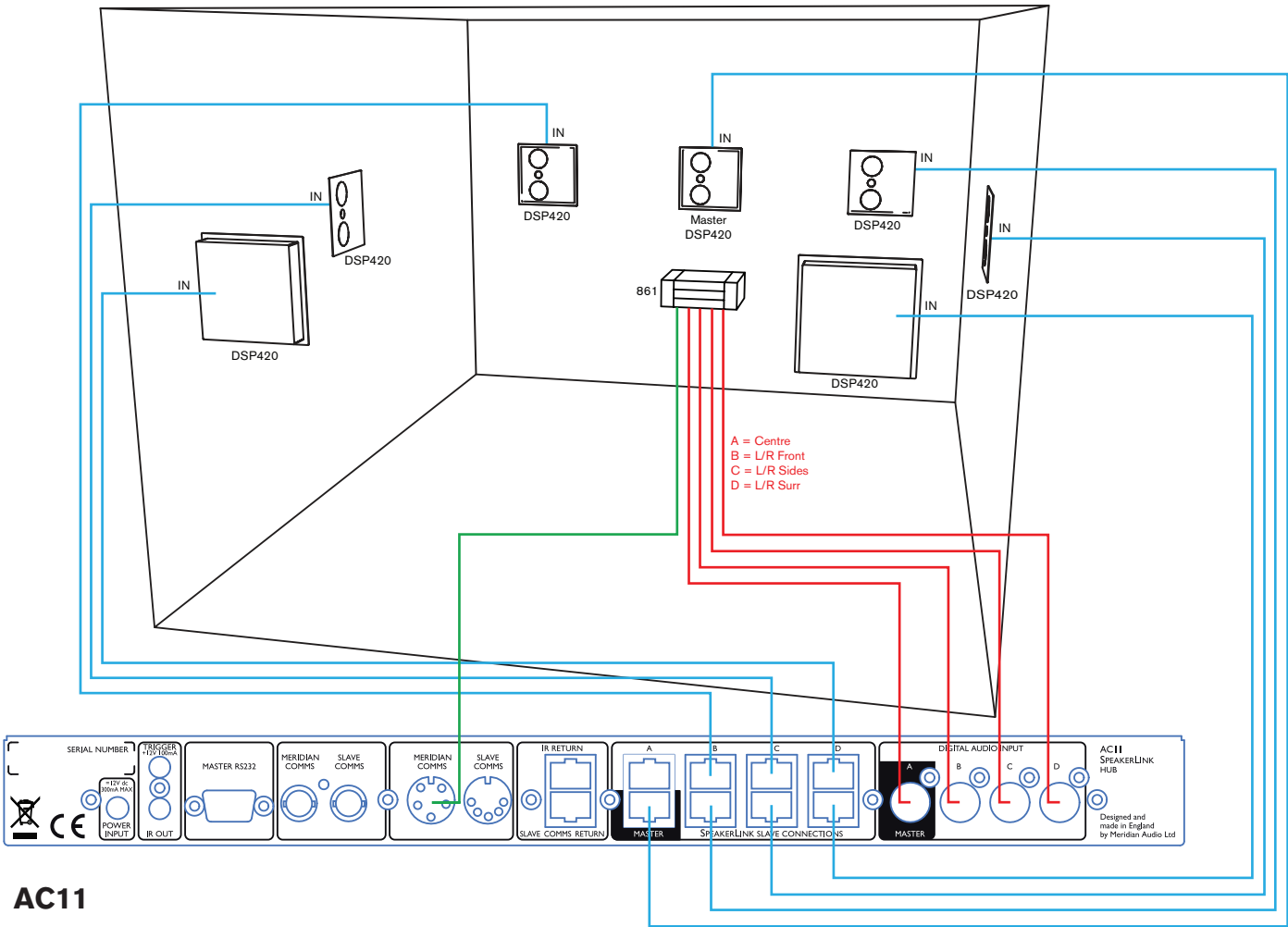

#### AC11

Meridian America Inc  
8055 Troon Circle Suite C,  
Austell, Atlanta  
GA 30168-7849, USA  
T +1 (404) 344 7111 F +1 (404) 346 7111

Meridian Audio Limited  
Latham Road,  
Huntingdon,  
Cambridgeshire PE29 6YE, UK  
T +44 (0) 1480 445678 F +44 (0) 1480 445686

www.meridian-audio.com

MERIDIAN